

RKCN

Konfektionierbarer Steckverbinder, M12-Kupplung mit Sechskant-Edelstahlverschraubung, Konfektionierung über Schraubklemmen
 – besonders für den Einsatz in Nahrungsmittelmaschinen geeignet –

Field attachable connector, M12 female connector with stainless steel hexagon threaded joint, assembling with screw terminals
 – especially designed for use in food processing equipment –

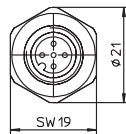
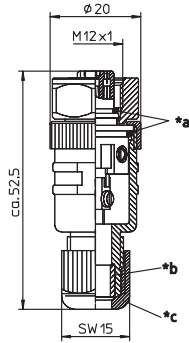

- *a O-Ring
O-ring
- *b Dichtung
gasket
- *c Hutmutter
cap nut

RKCWN

Konfektionierbarer Steckverbinder, M12-Winkelkupplung mit Sechskant-Edelstahlverschraubung, Konfektionierung über Schraubklemmen
 – besonders für den Einsatz in Nahrungsmittelmaschinen geeignet –

Field attachable connector, M12 female right angle connector with stainless steel hexagon threaded joint, assembling with screw terminals
 – especially designed for use in food processing equipment –

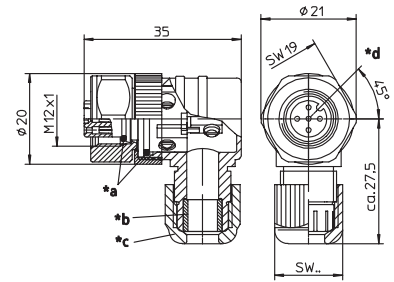

- *a O-Ring
O-ring
- *b Dichtung
gasket
- *c Hutmutter
cap nut
- *d Einsatz um 90° drehbar
insert 90° rotatable

**Pinbelegung
Pin assignment**

**4-polig
4 poles**















**5-polig
5 poles**



**8-polig
8 poles**



Technische Daten		Technical data	
Umgebungstemperatur	-25°C / +90°C 8-polig -25°C / +85°C	Operating temperature range	-25°C / +90°C 8 poles -25°C / +85°C
Werkstoffe		Materials	
Gehäuse / Griffkörper	PBT	Housing / Molded body	PBT
Kontaktträger	PBT	Insert	PBT
Kontakt	CuZn, unterkupfert, CuSnZn 8-polig unternickelt, vergoldet	Contact	CuZn, pre-coppered, CuSnZn 8-poles pre-nickeled, gold-plated
Gewindebuchse / Rändel- schraube/-mutter / Sechskant- schraube/-mutter / Hülse	Edelstahl	Receptacle shell / knurled screw/ nut / hexagon screw/nut / sleeve	stainless steel
O-Ring	FKM	O-ring	FKM
Mechanische Daten		Mechanical data	
Schutzart	IP 67 Nur im verschraubten Zustand mit den dazugehörigen Gegen- stücken.	Degree of protection	IP 67 Only in locked position with its proper counterparts.
Anschlussart	Schraubanschluss	Mode of connection	screw terminals
Anschließbarer Leiter	4- bis 5-polig max. 0,75 mm ² 8-polig max. 0,50 mm ²	Connectable conductor	4–5 poles max. 0.75 mm ² 8 poles max. 0.50 mm ²
Elektrische Daten		Electrical data	
Durchgangswiderstand	≤ 5 mΩ	Contact resistance	≤ 5 mΩ
Nennstrom bei 40°C	4- bis 5-polig 4 A 8-polig 2 A	Nominal current at 40°C	4–5 poles 4 A 8 poles 2 A
Nennspannung	4-polig 240 V 5-polig 60 V 8-polig 30 V	Nominal voltage	4 poles 240 V 5 poles 60 V 8 poles 30 V
Bemessungsspannung	4-polig 250 V 5-polig 63 V 8-polig 36 V	Rated voltage	4 poles 250 V 5 poles 63 V 8 poles 36 V
Prüfspannung	4-polig 2,0 kV eff. / 60 s 5-polig 1,5 kV eff. / 60 s 8-polig 0,9 kV eff. / 60 s	Test voltage	4 poles 2.0 kV eff. / 60 s 5 poles 1.5 kV eff. / 60 s 8 poles 0.9 kV eff. / 60 s
Isolationswiderstand	> 10 ⁹ Ω	Insulation resistance	> 10 ⁹ Ω
Verschmutzungsgrad	3	Pollution degree	3

Bestellbezeichnung Designation		Polzahl Poles	Kabelverschraubung Screw joint for cable	
RKCN 4/7	RKCWN 4/7	4	Ø 3,0–6,5 mm /SW 15	  
RKCN 4/9	RKCWN 4/9		Ø 4,0–8,0 mm /SW 19	  
RKCN 5/7	RKCWN 5/7	5	Ø 3,0–6,5 mm /SW 15	  
RKCN 5/9	RKCWN 5/9		Ø 4,0–8,0 mm /SW 19	  
RKCN 8/9			Ø 4,0–8,0 mm /SW 19	