



| | |
|--|---------------------------|
| Data Sheet | CE6323 |
| RJ45 CAT.5 Stewart SS37 (ED-IE-AX-RJ-5) | Valid from: 11.09.2012 |

Description

Field mountable Industrial Ethernet connector in shielded version with bend protection, anti-kink protection and cable management bar suitable for industrial applications, for structured cabling for office building applications, data centers and home networks.



Mechanical characteristics

| | |
|--|-------------------------------------|
| Mating cycles with RJ45 jack (SCS) | 750 max. |
| Standard color of anti-kink protection cover | Light-grey |
| Material of housing | Polycarbonat (UL94-V0) |
| Contact material | Copper Alloy |
| Contact plating | 1,27 µm selective hard-gold plating |

General characteristics

| | |
|--------------------------------------|---------------------------------|
| Standards | RJ45 connector acc. to TIA-1096 |
| Suitable for stranded and solid wire | AWG26 – AWG28 |
| Core outer diameter | 1,07 mm max. |
| Cable outer diameter | 5,72 mm |
| Temperature range | -40°C up to +85°C |

Approvals

| | |
|-----------|---------------------------|
| Standards | RoHS conform (2002/95/EC) |
|-----------|---------------------------|

General information

STEWART is a registered trademark of Bell Fuse Inc.

Other colors are available upon request

Photographs are not to scale and do not represent detailed images of the respective products!

| | | |
|---|-----------------------|-------------|
| PNM, www.lappgroup.com | Document: CE6323EN_V0 | page 1 of 2 |
|---|-----------------------|-------------|



| | |
|--|---------------------------|
| <h1>Data Sheet</h1> | CE6323 |
| RJ45 CAT.5 Stewart SS37 (ED-IE-AX-RJ-5) | Valid from: 11.09.2012 |

Technical drawings and dimensions

The **overall length [L]** of the assembled connector is: 33,5 mm (±0,5 mm)

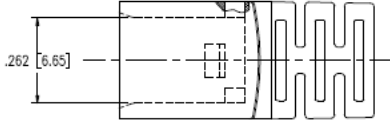
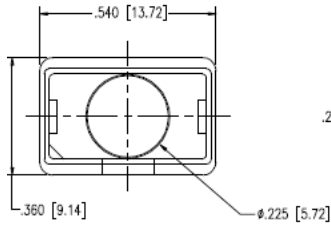
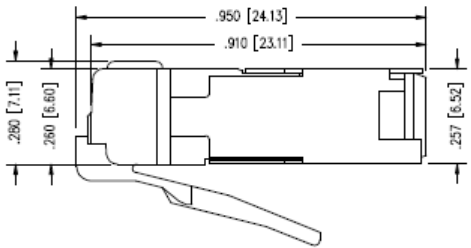
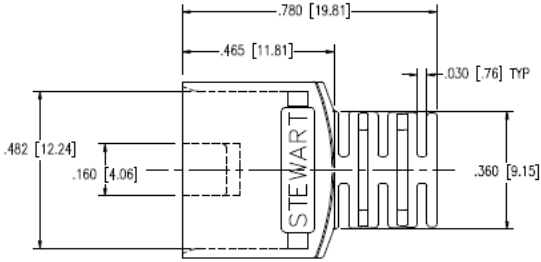
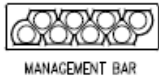
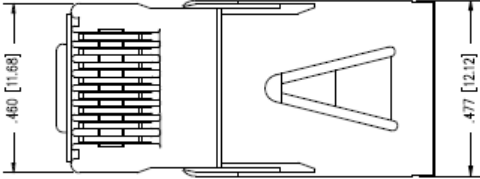
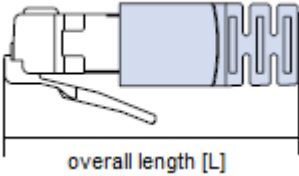

Plug assembly

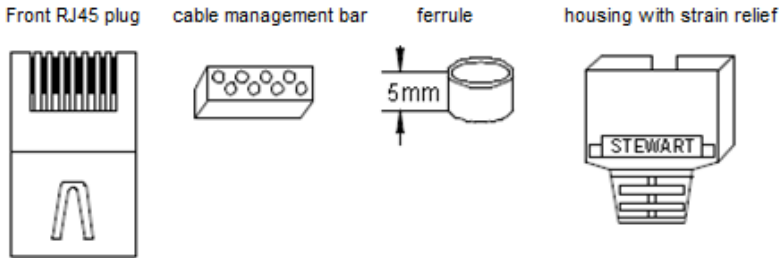

The RJ45 connector CE6323 contains 4 parts in total

